

Manhole Castings L-36

Round & Square Extension Rings

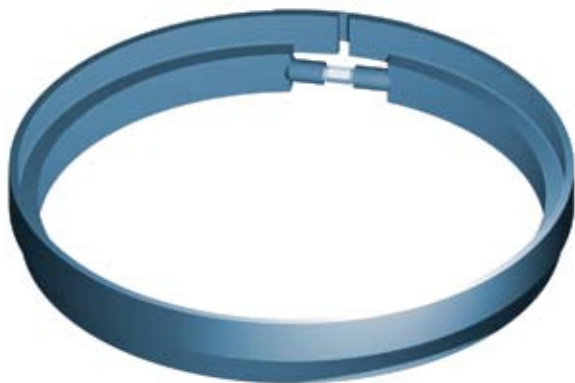

Extension rings are designed to raise the height of the manhole cover or grate without having to raise the frame. One man can quickly install an extension ring, adjust it and replace the cover.

Benefits:

- Saves time and money
- Lightweight and easy to install
- Adjustable for tight fit and close tolerance
- Available in 1", 1½" and 2" heights

Fabricated Steel Specs:

- Risers are manufactured of A-36 steel.
- All welding to American Welding Society specifications.
- Upper sections are 3/8" thick, lower sections are 3/4" thick, continuously welded.
- Adjustment device is solid 3/4" Type 304 stainless steel. Not plated mild steel nuts, which quickly deteriorate after installation.
- Adjustment nus are solid 1" x 1 3/4" C1010 steel.
- Coated with black asphalt paint.

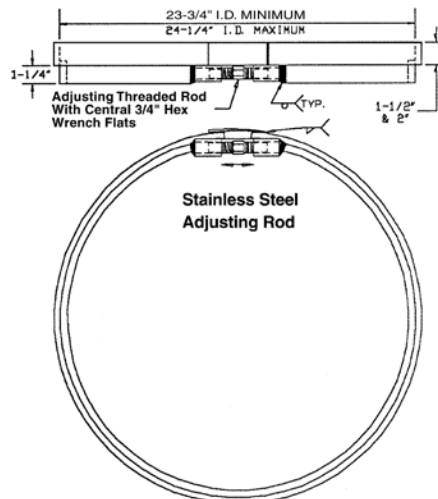

Ordering Info:

- Various designs to meet all street situations. For best possible fit, please supply the following information:
- Cover diameter
- Cover thickness
- Frame seat inside diameter
- The height of rise

DESCRIPTION	PRODUCT NUMBER
QWP	
23.75-24.25 x 1 MH Riser Ring	62004 600 1
23.75-24.25 x 1.5 MH Riser Ring	62004 600 15
23.75-24.25 x 2 MH Riser Ring	62004 600 2
25.75-26.25 x 1 MH Riser Ring	62006 600 1
25.75-26.25 x 1.5 MH Riser Ring	62006 600 15
25.75-26.25 x 2 MH Riser Ring	62006 600 2
31.75-32.25 x 1 MH Riser Ring	62009 600 1
31.75-32.25 x 1.5 MH Riser Ring	62009 600 15
31.75-32.25 x 2 MH Riser Ring	62009 600 2

DESCRIPTION	PRODUCT NUMBER
LEBARON	
24" x 1" Square MH Riser LES2410-3	66102
24" x 1.5" Square MH Riser LES2415-3	66102 1
24" x 2" Square MH Riser LES2420-3	66102 2
26" x 1" MH Riser Ring LER2610-3	66103
26" x 1.5" MH Riser Ring LER2615-5	66103 1
26" x 2" MH Riser Ring LER2620-5	66103 2
32" x 1" MH Riser Ring LER3210-3	66104
32" x 1.5" MH Riser Ring LER3215-3	66104 1
32" x 2" MH Riser Ring LER3220-5	66104 2