

# Pipe A-11

# PVC Pressure Pipe

## 800-EJP-24 HR

### AWWA C-905 Large Diameter

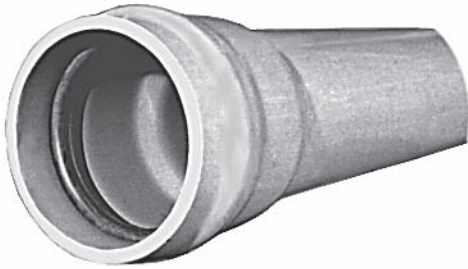

#### Large Diameter PVC Pressure Pipe Ductile Iron O.D.

High capacity transmission pipes with Ductile Iron O.D.'s in pressure ratings of 100 PSI (DR-41), 165 PSI (DR-25) and 235 PSI (DR-18) come in 14" thru 30" sizes. These pipes advance extrusion technology and bring proven PVC pipe efficiency and durability to a wider range of buried fluid transfer systems such as raw and finished water supplies, sewage force mains and irrigation systems.

PIPE SIZE	O.D.	PRODUCT NUMBER		
		DR & PRESSURE RATING		
		DR-41 100	DR-25 165	DR-18 235
14"	15.30	22315	—	—
16"	17.40	22330	22335	—
18"	19.50	—	—	—
20"	21.60	—	22343	—
24"	25.80	—	—	—
30"	32.00	—	—	—

**NOTE:** Installation guides are available upon request. Ask for one at your local EJP sales office.

#### Ductile Iron O.D.

Available in 14", 16", 18", 20", 24", and 30" sizes, C-905 pipe can be connected directly into cast and ductile iron fittings without adaptors or complicated procedures. Fabricated, non-metallic fittings are available in standard and special configurations.\*

#### Service Life

Because it is non-metallic, the pipe does not lose strength due to potable water corrosion, external galvanic corrosion or soil corrosion.

#### Flow Capacity

C-905 PVC pipe has a smooth interior that stays free from scouring and pitting thus providing long years of service with no loss in carrying capacity. Its coefficient of flow is C=150 (Hazen & Williams)—the best available for common use in water systems. This increased capacity permits savings in pumping costs as well as savings on the size of pipe required.

#### Meets Accepted Standards

Pipe shall meet the requirements of AWWA C-905.

#### NOTES:

- See Section B for mechanical joint fittings available for use with large diameter PVC pressure pipe.
- See Section B for restraining devices used with PVC pipe.

\* Non-metallic fittings are custom fabricated to meet your needs. Please call for pricing and availability.